

# LEGAL AND ADDITIONAL INFORMATION

## SMARTIFY YOUR BUSINESS. PRINTING INNOVATION.

In modern society, keeping up with technology is critical to the success of any business or the productivity of any individual. The choice of technology can be the difference between survival and leadership.

As the workplace becomes more digitized and the workforce becomes more mobile, printer and copier devices must also adapt and evolve.

Printer technology and satisfaction lag the electronics innovation most employees expect. Nor has there been any major entrant to help shake change.

Until now.

Samsung is applying its ingenuity to develop breakthrough printing solutions that ignite productivity. Only Samsung has the electronics expertise to design and build a printer that fits the way society works today.

Printing for the modern world has arrived.

**Samsung is printing innovation.**

For more information  
about Samsung Printing Solutions,  
visit [www.samsung.com/PrintingInnovation](http://www.samsung.com/PrintingInnovation)



## About Samsung Electronics Co., Ltd.

Samsung Electronics Co., Ltd. inspires the world and shapes the future with transformative ideas and technologies, redefining the worlds of TVs, smartphones, wearable devices, tablets, cameras, digital appliances, printers, medical equipment, network systems and semiconductors. We are also leading in the Internet of Things

space through, among others, our Digital Health and Smart Home initiatives. We employ 307,000 people across 84 countries. To discover more, please visit our official website at [www.samsung.com](http://www.samsung.com) and our official blog at [global.samsungtomorrow.com](http://global.samsungtomorrow.com).

## GENUINE SAMSUNG SUPPLIES

**Real value. True performance.**

Always make the right impression  
by using genuine Samsung supplies.



For more information  
about genuine Samsung supplies,  
visit [www.samsung.com/GenuineSupplies](http://www.samsung.com/GenuineSupplies)



## SAMSUNG BUSINESS

Copyright © 2015 Samsung Electronics Co., Ltd. All rights reserved. Samsung, Business Pro Printing Solutions™, SecuThru, SmarThru and are either trademarks or registered trademarks of Samsung Electronics Co., Ltd. Specifications and designs are subject to change without notice. Non-metric weights and measurements are approximate. All data were deemed correct at time of creation. Samsung is not liable for errors or omissions. All brand, product, service names and logos are trademarks or registered trademarks of their respective owners and are hereby recognized and acknowledged.

Android is a trademark of Google Inc.

Hancom Office is a registered trademark of Hancom Inc.

Microsoft, Excel, Microsoft Office, PowerPoint, Windows and Windows

Vista are registered trademarks of Microsoft Corporation in the United States and/or other countries.

TÜV Rheinland is a registered trademark of the TÜV Rheinland Group.

Samsung Electronics Co., Ltd.

129 Samsung-ro, Yeongtong-gu, Suwon-si, Gyeonggi-do 443-742, Korea

[www.samsung.com](http://www.samsung.com)



Samsung Multifunction

# SMART MultiXpress

K7600 | K7500 | K7400 Series

Office Transformation.  
Innovated for You.



**SMARTIFY  
YOUR BUSINESS.**  
PRINTING INNOVATION.

**SAMSUNG**  
BUSINESS

# GO BEYOND YOUR WORK CAPABILITIES WITH **SMART PRINT INNOVATION**

Take business performance to a new level with smart printing



## A3 printer market trends

The A3 mono printer market is decreasing in terms of value, primarily in the 45 to 90 ppm models and the number of units sold in this segment is relatively stagnant. However, a unit growth potential is possible in targeting entry-level models in the segment. Vertical markets, such as professional service organizations, financial institutions, insurance companies, and government and public service agencies, comprise a large market share due to their high average monthly print volume (AMPV).

These high-print-volume vertical markets all demand the same key requirements when choosing multifunction printers (MFPs). Fast, high-quality deliverables are essential to any business in order to enhance productivity and project a professional image to customers. Reliability is also vitally important to ensure high productivity and efficiency by minimizing equipment failures and providing an agile response when needed. In addition, scalability with software tailored to specific business needs is a key factor in succeeding in the ever-changing business environment.

## Samsung's flagship A3 mono multifunction printers (MFPs)

### SMART MultiXpress K7600 / K7500 / K7400 Series

These powerful K7600 series of MFPs are specifically designed to respond to the growing A3 printer market trend, boasting smart usability that enables businesses to work faster and more efficiently with intuitive, user-friendly controls. Equipped with high-performance, cost-efficient features and embedded security, Samsung K7600 series MFPs meet the demands of businesses that depend on high-volume printing with low total cost of ownership (TCO).

#### SL-K7600GX Series:



K7600GX (60 ppm)



K7500GX (50 ppm)



K7400GX (40 ppm)

#### SL-K7600LX Series:



K7600LX (60 ppm)



K7500LX (50 ppm)



K7400LX (40 ppm)

## Weigh the advantages of K7600 series printers

### Do more twice as fast

- 1.5 GHz quad-core CPU, enabling 2X faster print speeds compared to a dual-core CPU
- Up to 240 images per minute (ipm) using a Dual-Scan Document Feeder (DSDF) (GX model only)
- 1,200 dpi high resolution for quality output
- Next-generation toner technology for superb finishes
- Rendering Engine for Clean Page (ReCP) technology for sharp images

### Work Smarter

- Smart UX Center powered by Android™ on the 90-degree pivoting screen for full-page previewing
- Custom Launcher and Printing App Center
- Wireless option with Active NFC

### Remain worry-free

- Best-in-class maximum monthly duty (up to 300K)
- Samsung Smart Printer Diagnostic System (SPDS) app, providing the ability to fix printing issues from virtually anywhere
- Samsung eXtensible Open Architecture (XOA), providing customized printing solutions to maximize efficiency and security

# GET YOUR JOBS DONE 2X FASTER IN SUPERB QUALITY

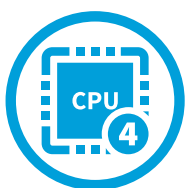

Print every second (Processing)

## Powerful quad-core CPU

The Samsung MultiXpress K7600 series of MFPs boasts the industry's first quad-core 1.5 GHz CPU with System-on-Chip (SoC) technology, delivering high-performance interpreting and rendering emulation. This robust CPU provides the power and capacity to accomplish print and copy tasks of virtually any size or complexity swiftly, as fast as a print every second. As a result, businesses can run much more productively and efficiently using high-performance, high-speed K7600 series MFPs.

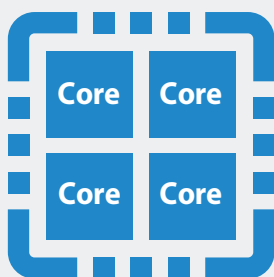

QUAD-CORE  
1.5 GHz CPU



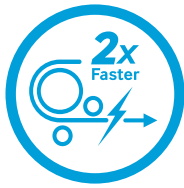

Get sharper-quality print output

## Two times faster dual scanning

The K7600 MFPs deliver best-in-class document scanning speeds with a Dual-Scan Document Feeder (DSDF) feature, which scans both sides of a document at the same time. These workhorse printers can dual-scan up to 240 ipm, twice the scanning speed of the K4300 series and six times that of other printers, which typically scan at 36 ipm. This blazing-fast scan speed equates to four pages being scanned every second, raising digital copy processing time considerably, as well as productivity.

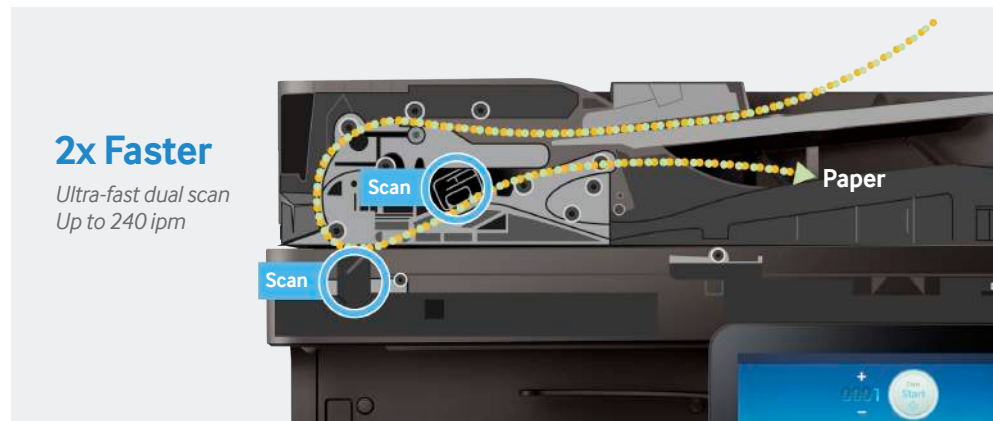

Work more efficiently

## Enhanced productivity with variable options

Various options are available to boost productivity, including a 2,250-sheet booklet finisher and a 3,250-sheet high-volume finisher that automatically staples up to 65 sheets, for high-volume document handling. An inner finisher can separate, collate and staple up to 50 sheets. Various punch kits are also available. Users can print up to 6,140 pages with a side and bottom High-Capacity Feeder (HCF).



Get clear results with micro-rendering (Rendering)

## Crisp 1,200 x 1,200 dpi resolution

Samsung K7600 MFPs are equipped with a high-quality Laser Beam Scanning Unit (LSU) that produces consistently sharp output. Using micro-rendering to smooth out rasterized edges and a 1,200 x 1,200 dpi resolution, the K7600 MFPs provide crisp printouts every time. That equates to two times the resolution of typical printers. When the printed materials look good, the company looks good.



Obtain high-gloss output (Printing)

## The next-generation toner technology for superb finishes

Samsung uses advanced chemistry in its toner cartridges to ensure the best finishes possible for every printout. Using its next-generation polymerized toner development, Samsung has achieved a nine percent reduction in fixation temperature, which means toner adhesion can be accomplished at a lower temperature, from 170°C (338°F) down to 155°C (311°F). A lower fixation temperature translates to lower energy consumption.



Get cleaner output

## Rendering Engine for Clean Page (ReCP)

Samsung's unique ReCP technology delivers quality output with clear text and images, ensuring a quality printout ensuring consistently perfect-looking results. The innovative technology automatically sharpens the focus of both graphics and text, resulting in clean-looking printouts.



# WORK SMARTER WITH AN INTUITIVE USER EXPERIENCE



Work SMART, just like on a tablet

## User-friendly Samsung SMART UX Center on a 90-degree pivoting screen

Samsung K7600 MFPs are designed with the smart-generation users in mind, boasting the industry's first Android-based printing UX. The Samsung SMART UX Center 2.0 functions just like a tablet with an intuitive touch-to-print display screen for easy use and is compatible with various Android-based devices. Included are custom widgets for creating instant, one-tap access to frequently used functions. This customizable user interface (UI) further simplifies operation and can be shared with various fleets.

For enhanced usability, Samsung's unique display pivots 90 degrees for full-page portrait or landscape viewing. This innovative feature enables users to easily review and edit their documents before printing without zooming or having to return to their PCs. In addition, applications, such as Hancorn Office®, support the horizontal view mode and edits of Microsoft® Office® Word, PowerPoint® and Excel® documents.

Samsung's new Smart Workspace lets users complete jobs with their preferred UI, address book and files virtually anywhere. The workspace can even be personalized to suit individual needs with preloaded applications and widgets for one-tap access to frequently used functions.

\* Will be available in Mar, 2015 on the Printing App Center

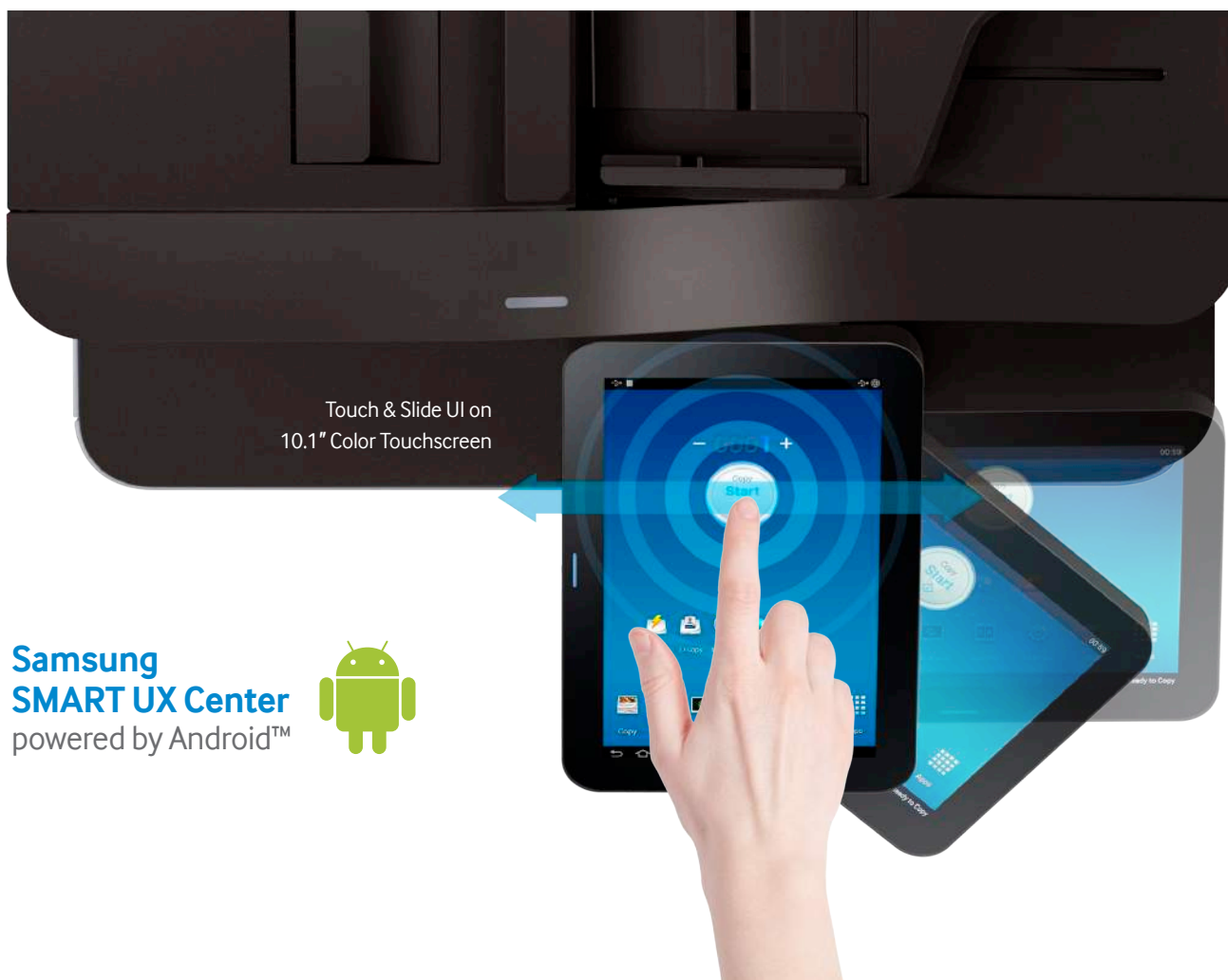



Enjoy your own SMART UX with various apps

## Custom launcher and Samsung Printing App Center

As your needs change, the Smart UX Center changes with you, thanks to its app-based extensibility. You can add the company logo and custom widgets for one-click access. The Auto Start option lets you execute a function with just one touch, simplifying workflow.

Samsung's new Printing App Center enables users to easily set up the printers by simply downloading essential apps from the app center's web portal.

- **Workbook Composer:** Exports multiple selected areas automatically
- **HanCom Office®:** Enables viewing and editing of Microsoft® Office® and Hangul Word Processor (HWP) files directly at the printer
- **Smart Color Manager:** Manages color settings at the printer
- **Launcher:** Streamlines basic copy, scan or fax jobs with easy widgets
- **Smart Service:** Facilitates printer troubleshooting

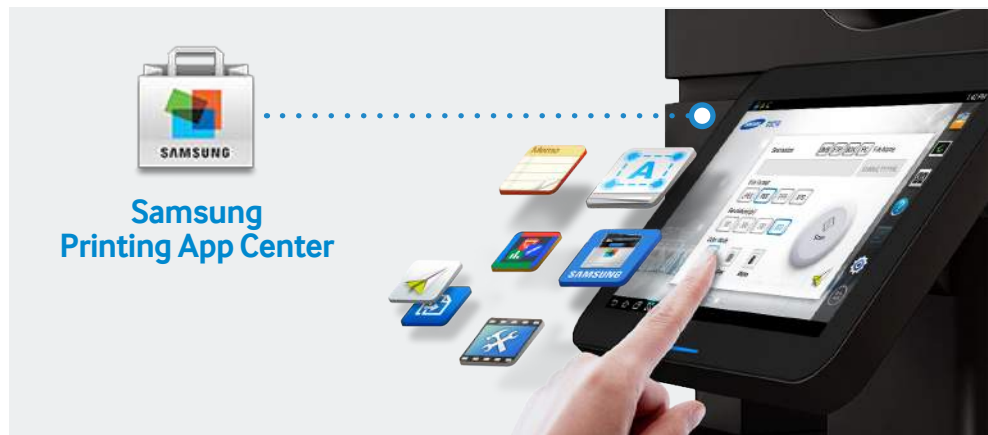

Tap to print with NFC technology

## Wireless option with NFC Pro

Just when it seemed printing couldn't get any more convenient, users can now connect and print with ease using Samsung's K7600 MFPs with advanced NFC technology. Simply tap, then print, scan or fax documents from any NFC-supported mobile device. The wireless option with NFC Pro provides user authentication through a mobile device, easy wireless setup and device cloning with Samsung MobilePrint Control and Samsung MobilePrint Manager apps.



\* NFC Pro is only available for Android 4.0 and above.  
\* NFC Pro is provided as options, SL-NWE001X and SL-NWE002X.



# REMAIN WORRY-FREE FROM DOWNTIME AND TROUBLESHOOTING



Reduce costs with high durability

## Best-in-class maximum monthly duty (up to 300K)

The Samsung K7600 series MFPs boast the best-in-class maximum monthly duty, delivering high durability and ensuring cost reduction and freedom from trivial work typically spent changing toner cartridges, drums and developer.

### Toner Capacity\*

45,000 pages

### Drum Capacity\*

450,000 pages

\* Estimated Toner Yield @ 6% coverage. For best performance and yield, we recommended using genuine Samsung parts and consumables.

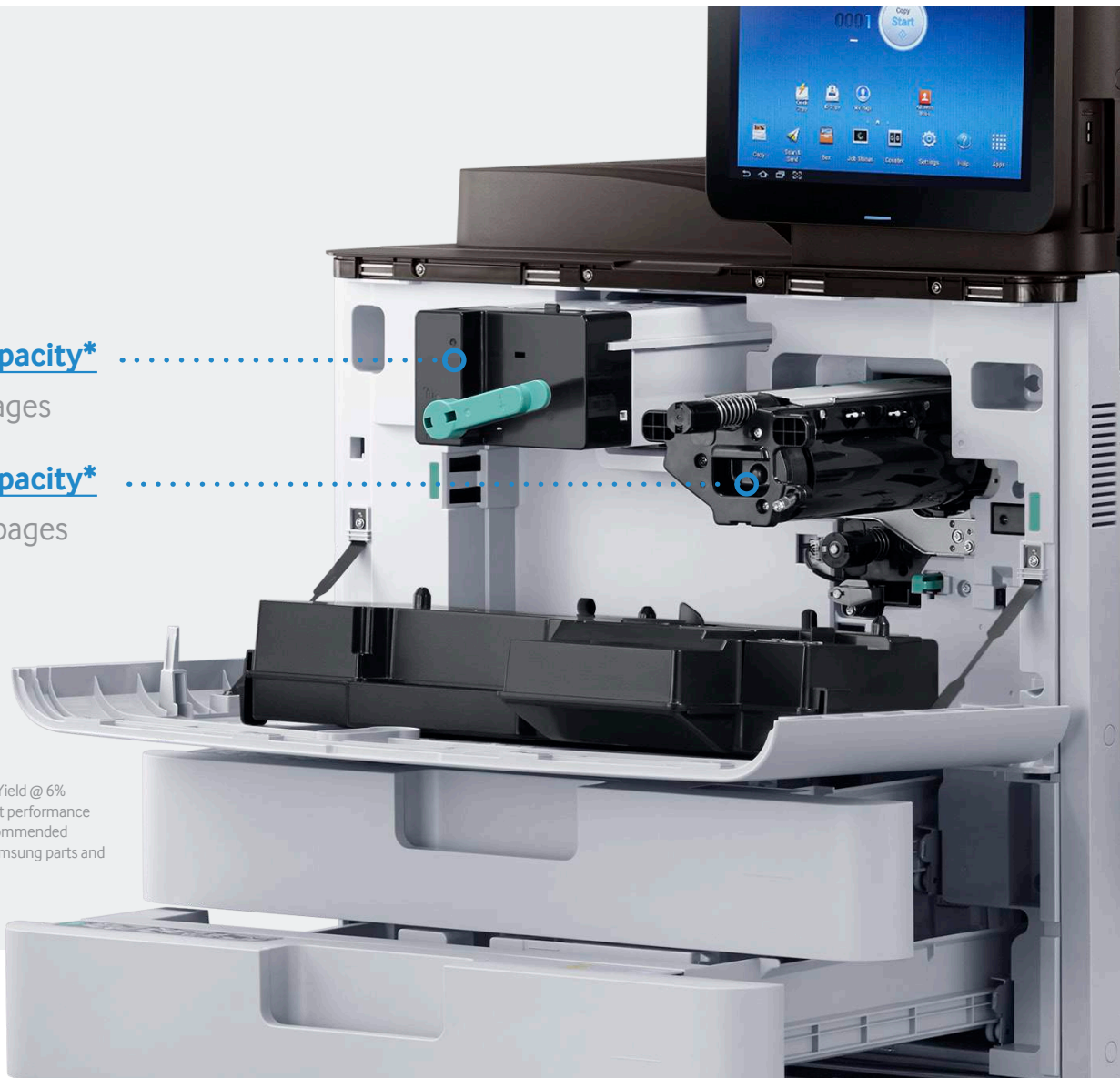



Diagnose print issues on the go

## Easy-to-use Samsung Smart Printer Diagnostic System (SPDS)

Printer failures are never welcome occurrences. But when they happen while you are away from the office or pressed for time, they are that much more frustrating. With Samsung SPDS-equipped K7600 MFPs, downtime is minimized, whether you are working across the office or on the other side of the globe.\* SPDS is a smartphone app that's a service tool for diagnosing printer failures. It can also send preemptive alerts to smartphones, addressing issues before they occur. The app provides the latest information on Samsung MFPs in real time, using pictures and videos of its components, as well as measurement guides, to simplify troubleshooting, even for those with little technical knowledge. The ability to solve printer issues quickly without a service technician saves time and costs.

\* MX7 contents will be available beginning February 27, 2015.



Ensure a secure print operation

## XOA output management (security) solutions

Samsung's XOA platform provides customized enterprise solutions for integration with our K7600 MFPs to satisfy specific business requirements. Our output management solutions provide cost-effective, secure print operations. SecuThru™ Lite 2 enhances document security and reduces costs with user authentication. The Usage Tracker controls printing expenses by easily tracking device functions.

Increase productivity with simplified management

## XOA document management (productivity) solutions

Samsung's document management solutions increase productivity and provide easy management along with security and efficiency. The solutions consist of SmarThru™ Workflow Lite, which increases productivity with its cost-saving automated workflow solution. Also included is the Secure Login Manager, which safeguards valuable data and devices from unauthorized use. Plus, Cloud Connector provides easy, secure access for scanning to and printing from the cloud.



Lower IT fleet management costs

## Fleet management solution

For businesses that have fleets of printing devices, Samsung provides a cloud-based fleet management solution for lowering IT department management costs. Business Pro Printing Solutions™ reduce TCO by increasing productivity with simple management. IT departments can monitor, maintain, service and supply an entire infrastructure of printers and MFPs remotely. Managers can create status alerts and receive notifications when alerts occur multiple times. Hundreds of thousands of devices can be easily managed and integrated into Enterprise Resource Planning (ERP) solutions from one server. Plus, customized reports can be created and distributed to key personnel on a regular basis.

# CUSTOMIZE YOUR MFP WITH FLEXIBLE PART OPTIONS

## With 25 total options

SSamsung offers businesses 25 different options that enable the printers to handle more documents, faster, adding value to the K7600 series MFPs by enhancing productivity. Options include a high-volume finisher that staples up to 65 sheets and a 25-sheet booklet finisher that assembles a 100-page booklet. Plus, each finisher conveniently comes equipped with the stapler. A high-class Wi-Fi protocol option, which supports an additional 5 GH compared with a typical 2.4 GHz speed, enables users to transmit highvolume data with reliable performance.

## Configurations & Options

● Factory Configured  
○ Optional

### Paper Output Option

**Job Separator**  
SL-JST501S



**Inner Finisher**  
SL-FIN502L



OR

**High-volume Finisher**  
SL-FIN701H



**Booklet Finisher**  
SL-FIN701B



OR

**Staples**  
(Inner, Booklet)  
SCX-STP000

**Staples**  
(Main for Booklet)  
SL-STP000

OR

**Punch Kit**  
(Inner - 2/3, 2/4, Swedish)  
SL-HPU501T,  
HPU501F, HPU501S

**Punch Kit**  
(Booklet - 2/3, 2/4, Swedish)  
SL-HPU701T,  
HPU701F, HPU701S

**120/240 IPM DSDf (GX model)**  
**80/160 IPM DSDf (LX model)**



**Multipurpose Table**  
SL-WKT101



**Work Table**  
CLX-WKT001



**Wireless/NFC Kit**  
SL-NWE002X, SL-NWE001X



**Additional Network Kit**  
SL-NWA001N



**FDI Kit**  
CLX-KIT10F



**Fax Kit**  
CLX-FAX160



**Dual Fax Kit**  
SL-FAX2501



**Cassette Locking Kit**  
SL-CLK501



### Paper Input Option

**Cabinet**  
SL-DSK501T



**DCF**  
SL-PFP501D



**HCF**  
SL-HCF501B



**HCF-Side**  
SL-HCF501S



\* HCF-side is not compatible with the Cabinet, SL-DSK501T.

# SAMSUNG MultiXpress

## K7600 | K7500 | K7400 Series

Technical details made to support your business

General Specifications		Paper Handling		Options	
Speed	- K7600 60 ppm in A4 / 31 ppm in A3 - K7500 50 ppm in A4 / 26 ppm in A3 - K7400 40 ppm in A4 / 21 ppm in A3	Paper Capacity	(Std) 1,140 Sheets / (Max) 6,140 Sheets	Double Cassette Feeder (SL-PFP501D)	
Processor	1.5 GHz Quad core	Media Size	- MP Tray: 98 x 148 mm - 320 x 457 mm (3.87 x 5.8 - 12.6 x 18 in.) - Tray 1: 98 x 148 mm - 297 x 390 mm - Tray 2: 148 x 210 mm - 320 x 457 mm (5.8 x 8.2 - 12 x 18 in.)	Capacity	1,040 Sheets (520 Sheets x 2)
Memory	6 GB (2 GB for Android OS)	Media Type	- MP Tray: Plain Paper, Thin Paper, Thick Paper, Bond, Punched, Preprinted, Recycled, Letterhead, Cotton, Colored, Archive, Cardstock, Label, Transparency, Envelope - Tray 1, 2: Plain Paper, Thin Paper, Thick Paper, Bond, Punched, Preprinted, Recycled, Letterhead, Cotton, Colored, Archive, Cardstock, Label, Envelope (Tray1 Only)	Media Sizes	140 x 210 mm - 320 x 457 mm (5.5 x 8.2 in. - 12 x 18 in.)
HDD	340 GB	Media Weight	- MP Tray: 60 - 325 g/m <sup>2</sup> : Simplex - Tray 1, 2: 60 - 300 g/m <sup>2</sup> 60 - 256 g/m <sup>2</sup> : Duplex	Media Types	Plain Paper, Thin Paper, Thick Paper, Punched Paper
Operational Panel	10.1" TFT LCD with Initial Cap Touch, Multitouch, Resolution: 900 x 600	ADF Document Size	Ledger / Letter / Legal / Oficio / Folio / A3 / A4 / JIS B5 / ISO B5 / Executive / A5 / A6 / Statement / Custom	Media Weight	60 to 300 gsm
Interface	High-speed USB 3.0, Ethernet 10/100/1,000 BaseTX, IEEE® 802.11 b/g/n (optional)	High-capacity Feeder - Bottom (SL-HCF501B)		Sensing	H/W Install Detect, Paper Empty & Low Level Detect, Paper Size Detect
Duty Cycle, Monthly	- K7600: 300,000 Pages - K7500: 250,000 Pages - K7400: 200,000 Pages	High-capacity Feeder - Side (SL-HCF501S)		Capacity	2,000 Sheets (80 g/m <sup>2</sup> / 20 lb bond)
Dimensions (W x D x H)	- K7600 / K7500 / K7400 GX Series 585 x 670 x 932.2 mm (23 x 26.4 x 36.7 in.) 585 x 670 x 1,188.4 mm (w/ stand) (23 x 26.4 x 46.8 in.) 585 x 670 x 883.7 mm (23 x 26.4 x 34.8 in.) - LX Series 585 x 670 x 1,139.9 mm (w/ stand) (23 x 26.4 x 44.9 in.)	Capacity	2,000 Sheets (80 g/m <sup>2</sup> / 20 lb bond)	Media Sizes	A4, Letter
Weight	- GX Series: 97.3 kg - LX Series: 84.3 kg	Media Types	Plain Paper, Thin Paper, Thick Paper, Punched Paper	Media Weight	60 to 300 gsm
Network Protocols	IP Management (DHCP, BOOTP, AutoIP, SetIP, Static) / Discovery Protocol (SLP, UPnP, Bonjour®, DNS, WINS) / Printing Protocol (TCP / IP, LPR, IPP, WSD) / Management Protocol (SNMPv1.2, SNMP3, SMTP, Telnet) / Scan Protocol (SMTP, FTP, SMB, WSD) / Security Protocol (SMB, Kerberos™, LDAP, IPsec, EAP)	Sensing	H/W Install Detect, Paper Empty & Low Level Detect	Inner Finisher (SL-FIN502L)	
Network Security	SSL / TLS, IPsec, SNMPv3, Protocol & Port Management, IPv6, IP / MAC Filtering, IEEE 802.1x support (optional)	Copy Specification		Capacity	500 Sheets Stacking, Internal
OS Compatibility	[Windows®] - Windows XP (32/64 bit) / 2003 (32/64 bit) / Vista® (32/64 bit) / 2008 / Win7 / 2008 R2 (64 only) / Win8 / 2012 / Win8.1 / 2012 R2 [Linux®] - Red Hat Enterprise Linux® WS 5, 6 (32/64 bit) - Fedora 12, 13, 14, 15, 16, 17, 18, 19, 20 (32/64 bit) - OpenSUSE 11.2, 11.3, 11.4, 12.1, 12.2, 12.3, 13.1 (32/64 bit) - Ubuntu® 10.04, 11.04, 11.10, 12.04, 12.10, 13.04, 13.10, 14.04 (32/64 bit) - SuSE Linux Enterprise Desktop 10, 11 (32/64 bit) - Debian™ 6, 7 (32/64 bit) - Mint 13, 14, 15, 16 (32/64 bit) [Mac] - Mac OS® X 10.6 - 10.10	First Copy Out Time	- K7600: 3.1 sec - K7500: 3.7 sec - K7400: 4.6 sec	Staple Capacity	5,000 Staples / Cartridge
Power Consumption	2.0 W (Sleep) / 60 W (Ready) / 1.3 kWh (Max)	Resolution	Up to 600 x 600 dpi	Stacking	- Top Tray: 50 Sheets (A4/LT @ 80 gsm) - Finishing Tray: 500 Sheets (A4/LT @ 80 gsm)
Print Specification		Zoom Rate	25% - 400%	Output Stacking	Face Down
Print Speed(A4)	- K7600: 60 ppm - K7500: 50 ppm - K7400: 40 ppm	Multi Copy	Up to 9,999	Booklet Finisher (SL-FIN701B)	
Resolution	1,200 x 1,200 dpi (optical) 9,600 x 600 dpi (enhanced)	Copy Features	Proof Copy / N-Up / ID Card Copy / Poster Copy / Image Repeat / Booklet / Covers / Transparencies / Book Copy / Interrupt Copy / Erase Edge / Save to File	Capacity	65 Sheets Stapling / 2,000 Sheets Stacking
Print language	PCL5, PCL6 (XL), PostScript Level 3, PDF 1.7, XPS	Scanner Specification		Staple Cartridge	5,000 Staples / Cartridge
Fax Specification (Optional)		Speed	- GX Series: 120/240 ipm - LX Series: 80/160 ipm	Stacking	- Top Tray: 250 Sheets (A4/LT @ 80 gsm) - Finishing Tray: 2,000 Sheets (A4/LT @ 80 gsm)
Modem Speed	33.6 Kbps	Compatibility	Network TWAIN, Network SANE	Output Stacking	Face Down
Compatibility	ITU-T G3, Super G3	Scan File Formats	PDF / Compact PDF / Searchable PDF / JPEG / XPS / TIFF-S / TIFF-M / TIFF	High-volume Finisher (SL-FIN701H)	
Resolution	203 x 98 dpi (Std), 203 x 196 dpi (Fin), 300 x 300 dpi (Super-fine), 600 x 600 dpi (Ultra-fine)	Resolution	600 x 600 dpi (Optical), 4,800 x 4,800 dpi (Enhanced)	Capacity	65 Sheets Stapling / 3,250 Sheets Stacking
Fax Functions	TTI / RTI / Auto Reduction / Multi-send (Same as Group Dial Capacity) / Delayed Send / Memory RX / Secure Rx (<-secure TX) / Time Secured Fax	Destination	Email, FTP, SMB, BOX, USB, WSD, PC	Staple Cartridge	5,000 Staples / Cartridge
Max. Line	2nd lines	Others		Stacking	- Top Tray: 250 Sheets (A4/LT @ 80 gsm) - Finishing Tray: 3,000 Sheets (A4/LT @ 80 gsm)
Consumable		General	Cabinet, Job Separator, Work Table, Multipurpose Table, Tray Locking Kit	Output Stacking	Face Down
Toner Capacity	(K) 45,000 pages	Network	Wireless / NFC Kit, Wireless / BLE / NFC Kit, Additional LAN Kit, FDI Kit, Fax Kit, Dual Fax Kit	Print Specification	
Drum Capacity*	(K) 450,000 pages	Punch Kit	Auto change 2/3 or 2/4 hole, Swedish 4	Print Speed(A4)	- K7600: 60 ppm - K7500: 50 ppm - K7400: 40 ppm
Waste Toner Container	300,000 pages	Print Specification		Resolution	1,200 x 1,200 dpi (optical) 9,600 x 600 dpi (enhanced)
Print Specification		Print language	PCL5, PCL6 (XL), PostScript Level 3, PDF 1.7, XPS	Print Specification	
Print Specification		Print language	PCL5, PCL6 (XL), PostScript Level 3, PDF 1.7, XPS	Print Specification	

Digital Revelation

www.digitalrevelation.co.za | 021 551 1206

\* Estimated Toner Yield @ 6% coverage. For best performance and yield, we recommended using genuine Samsung parts and consumables.